

- 1 Judy Watson
Bomb Drawing 1 1995
ink and watercolour on paper, 41 x 32.5cm
- 2 Matthew Davis
Skeins 2018-21
vinyl record and postcard
dimensions variable
- 3 Megan Cope
Mourning for Menindee 2020
dry clay, emu eggs with decal, cotton feathers,
fish scales, dimensions variable
- 4 Pam Diment
Maralinga 2015
clay, glaze, body stains, 50 x 20cm
- 5 Kumanara Boogar
Walpa (Wind) Bulga (Big) Maralinga 2008
acrylic on canvas, 95.5 x 71cm
- 6 Trent Crawford
Newclear (Single story reinforced masonry block
house) 2017
Newclear (Two story brick & cinder block house
with basement shelters) 2017
Newclear (Single story frame house rambler with
reinforced concrete bathroom) 2017
Newclear (LPG as pumping and distribution
station) 2017
silver gelatin prints, 60 x 47.5cm each
- 7 Rosemary Laing
one dozen considerations, Totem 1, Emu 2013
C type photograph, 48.6 x 77.1 x 6cm
one dozen considerations, Totem 2, Emu 2013
C type photograph, 112.6 x 196.6 x 7.4cm
- 8 Unbound Collective
Purple Flowers to Dust, 2021
Sovereign Acts | REFUSE 2018
digital video loop, 10:15 minutes
Sovereign Acts | In the Wake 2019
banana paper, archives, song and poetry
dimensions variable
- 9 eBay (Warren Paul)
Marcoo: 4 October 1956 2016
clay, earthenware, body stains, 35 x 22cm
Kite: 11 October 1956, 2016
clay, earthenware, 32 x 29cm
- 10 Jelena Telecki
Leader 2013
oil on canvas, 46 x 51cm
Leader II 2020
oil on linen, 48 x 53cm

- 11 Sanja Pahoki
A postcard from Jasenovac 2021
duratran, lightbox, 43 x 29cm
Baka rubs her eyes 2021
duratran, lightbox, 43 x 29cm
- 12 Mareike Bernien and Kerstin Schroedinger
Rainbow's Gravity 2014
HD video, 33 minutes
- 13 Hayley Millar Baker
Untitled (The best means, of caring for, and dealing
with them in the future) 2018
Untitled (So he mixed arsenic with half the flour
and a raging thirst was created) 2018
Untitled (The theft of the White men's sheep) 2018
inkjet on cotton, 80 x 100cm each

Artist acknowledgements:

Judy Watson and Megan Cope courtesy Milani Gallery, Brisbane. Rosemary Laing courtesy Tolarno Galleries, Melbourne. Kumanara Boogar courtesy the collection of Pam Diment. Pam Diment courtesy Pamela Burden. Sanja Pahoki courtesy Sarah Scout. Hayley Millar Baker courtesy Vivien Anderson Gallery, Melbourne. Matthew Davis would like to acknowledge Kerrie Poliness and Peter Haffenden.

Screening times:

Unbound Collective
Purple Flowers to Dust, 2021

This video is screened at 5 minutes past the hour, every hour from midday.

Mareike Bernien and Kerstin Schroedinger
Rainbow's Gravity 2014

This video is screened at 20 minutes past the hour, every hour from midday.

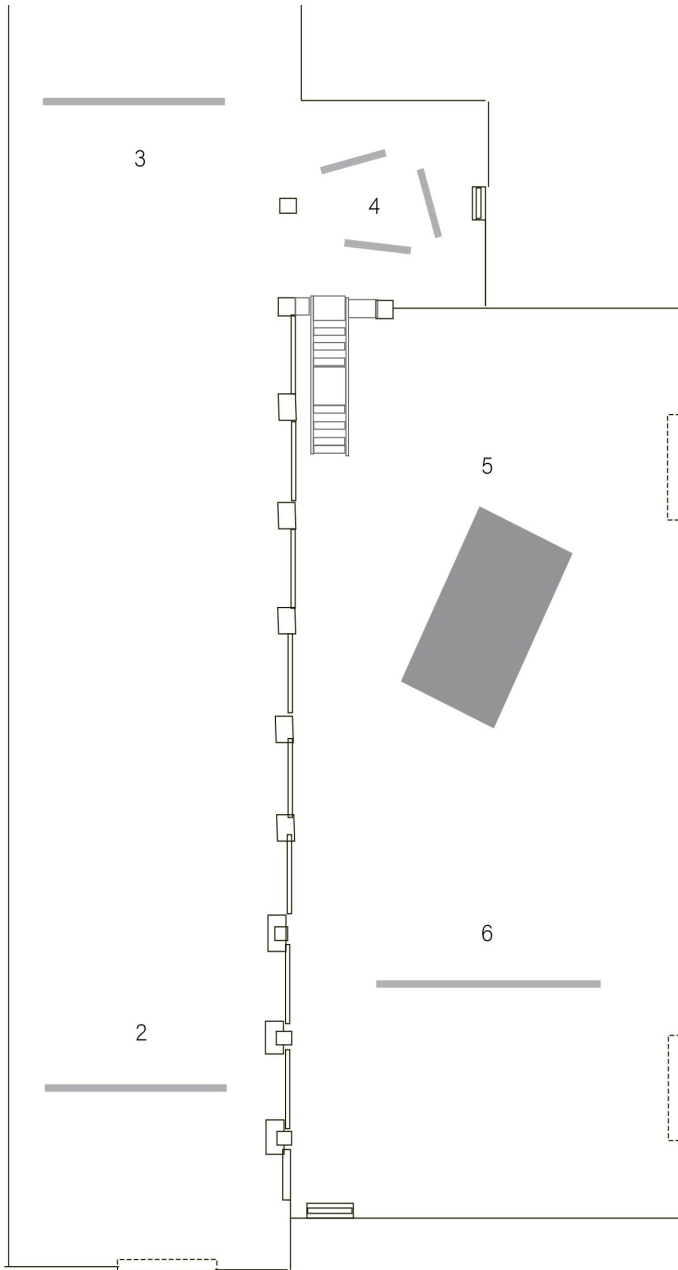

1

museum visitor centre ↓

- 1 Matthew Davis
Skeins 2018-21
two stereo audio files, 4 speakers, postcard
dimensions variable
- 2 Korpys/Löffler
Reflecting Absence 2016
super 8 film on digital video, 22:41 minutes
- 3 Judy Watson,
the witness tree 2018,
single channel video, four channel sound, 5:40min.
Video editor: Maria Barbagallo, Sound design:
Greg Hooper. Cinematography: Judy Watson,
Greg Hooper, Robert Andrew.
- 4 Ashley Perry
Reformation 2019–2021
steel, glass, monitors, three channel video,
200 x 200cm
- 5 Nina Sanadze
Apotheosis 2021
An original studio archive of a prominent soviet
monumental sculptor Valentin Topuridze (1907-
1980), plaster models, moulds and fragments.
1600 x 3100 x 600 cm
- 6 Phil Collins
zašto ne govorim srpski (na srpskom) 2008
single channel video projection, b/w and colour,
sound, 34:00 minutes

Screening times:

Judy Watson,
the witness tree, 2018

10:58:00 am
12.11:00 pm
01:14:00 pm
02:17:00 pm
03.20:00 pm

Phil Collins
zašto ne govorim srpski (na
srpskom) 2008

11:04:00 am
12.17:00 pm
01:20:00 pm
02:23:00 pm
03:26:00 pm

Korpys/Löffler
Reflecting Absence 2016

11:48:00 am
12:51:00 pm
01:54:00 pm
02:57:00 pm
04:00:00 pm

Artist acknowledgements:

Judy Watson courtesy Milani Gallery, Brisbane.
Phil Collins courtesy Shady Lane Productions,
Berlin. Korpys/Löffler courtesy Meyer Riegger,
Berlin. Matthew Davis would like to acknowledge
Kerrie Poliness and Peter Haffenden.

The image is not nothing (Concrete Archives)
13 May – June 26, 2021
Melbourne's Living Museum of the West
Pipemakers Park, Van Ness Avenue, Maribrynong
Thurs – Fri 11am–4pm; Sat 1 – 4pm